

PROJECT:
HIGHLAND WEST JR. HIGH
 901 N. SANTA FE MOORE, OK

PROJECT NUMBER: 23069
 DRAWING DATE: 09.25.23
 ISSUE DATE: 09.25.23

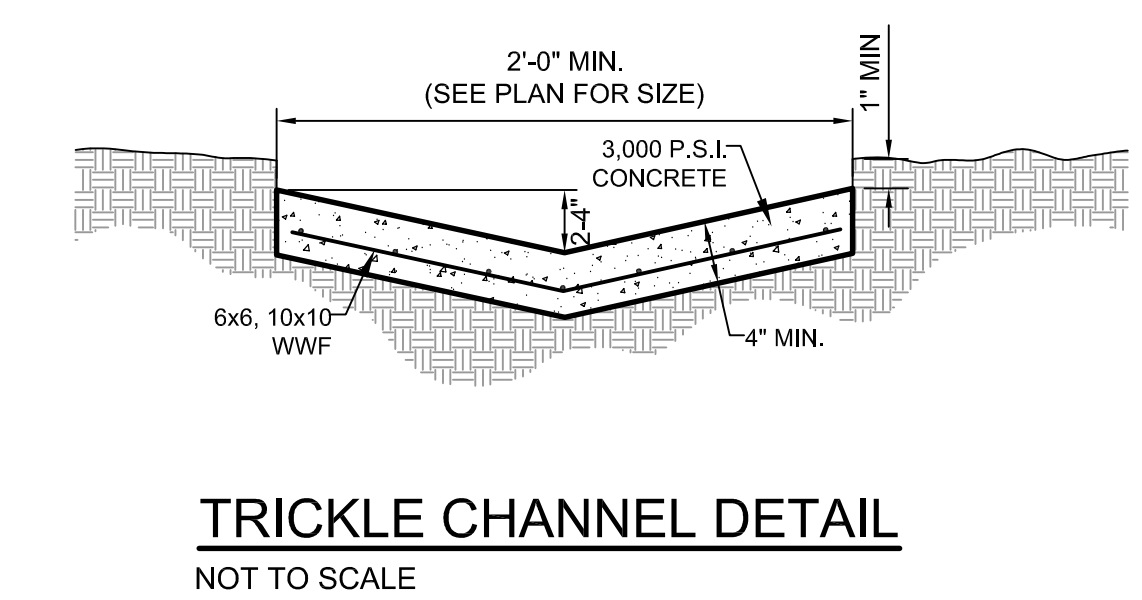
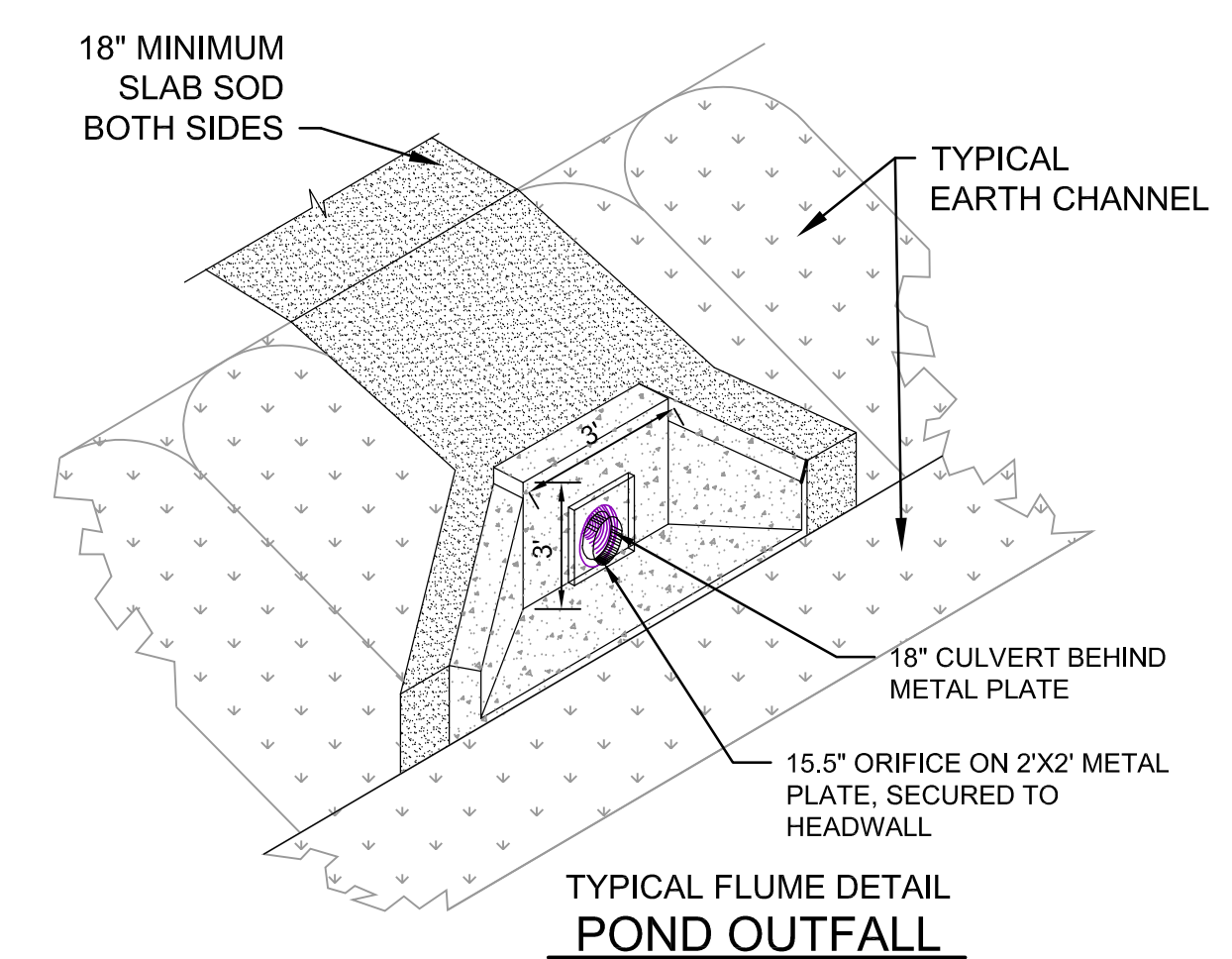
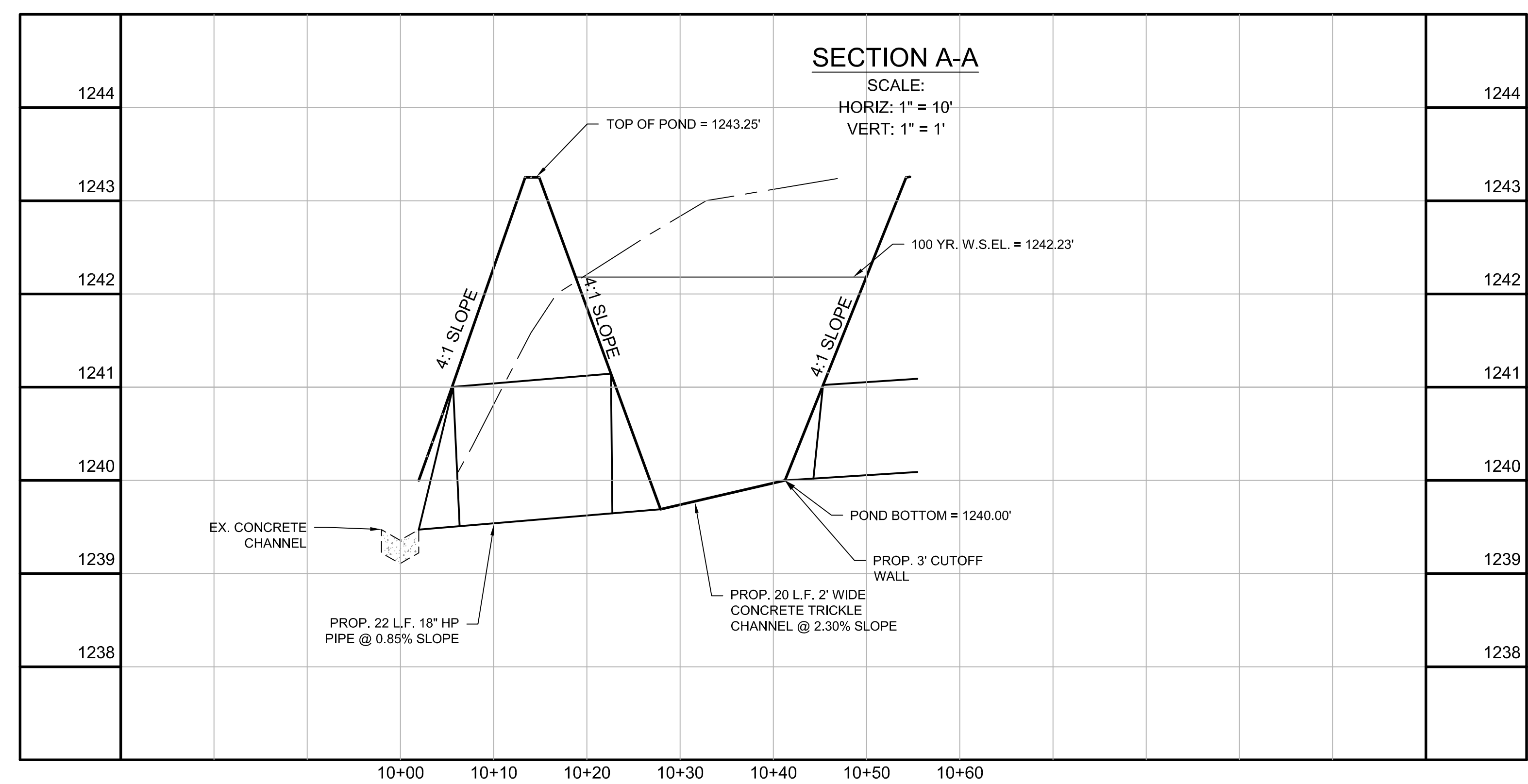

SEAL:

SUBMITTAL:
PERMIT SET

REVISIONS:

NO.	DATE	DESCRIPTION

THESE PLANS AND DRAWINGS ARE NOT TO BE REPRODUCED, CHANGED OR COPIED IN ANY FORM OR MANNER WHATSOEVER WITHOUT FIRST OBTAINING THE WRITTEN PERMISSION AND CONSENT OF CEDAR CREEK CONSULTING INC. THIS SHEET IS NOT TO BE USED FOR CONSTRUCTION UNLESS THE ISSUE DATE IN THE TITLE BLOCK COINCIDES WITH OR POST DATES THE DRAWING DATE. ANY CHANGES MADE FROM THESE PLANS WITHOUT CONSENT OF CEDAR CREEK CONSULTING INC. ARE UNAUTHORIZED AND SHALL RELIEVE CEDAR CREEK CONSULTING OF RESPONSIBILITY FOR ALL CONSEQUENCES ARISING OUT OF SUCH CHANGES.

DRAWING TITLE:
DETENTION POND PLAN

SHEET:
C3.03

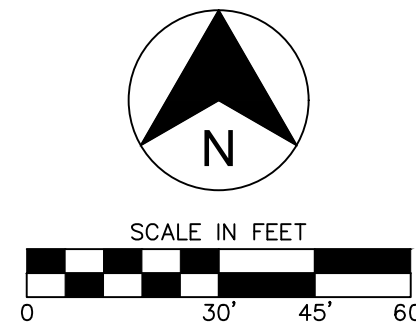

SITE DATA

TOTAL AREA OF CONSTRUCTION SITE : 1.80 ACRES
 TOTAL AREA TO BE DISTURBED: 1.80 ACRES
 CURRENT (EXISTING) IMPERVIOUS AREA: 0.38
 POST-CONSTRUCTION IMPERVIOUS AREA: 0.85
 POST CONSTRUCTION RUNOFF COEFFICIENT: C = 0.68

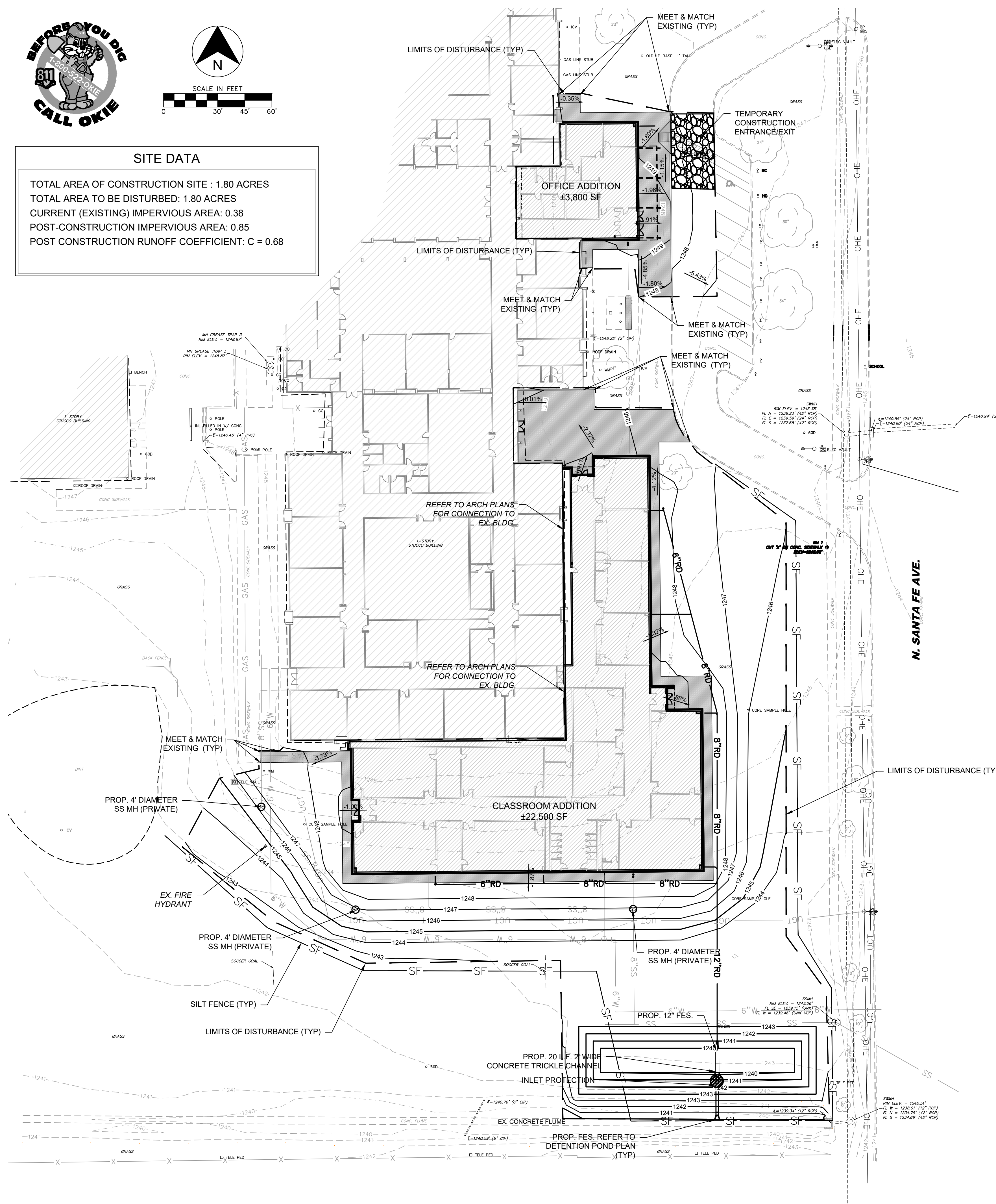

EROSION CONTROL NOTES

- A. SEDIMENT BASINS ARE ATTRACTIVE TO CHILDREN AND CAN BE VERY DANGEROUS. IN ALL CASES, LOCAL ORDINANCES AND REGULATIONS REGARDING HEALTH AND SAFETY MUST BE ADHERED TO.
- B. ALL CONTRACTORS AND SUBCONTRACTORS INVOLVED WITH STORM WATER POLLUTION PREVENTION SHALL OBTAIN A COPY OF THE STORM WATER POLLUTION PREVENTION PLAN AND THE STATE OF OKLAHOMA NATIONAL POLLUTANT DISCHARGE ELIMINATION SYSTEM GENERAL PERMIT (NPDES PERMIT) AND BECOME FAMILIAR WITH THEIR CONTENTS.
- C. ALL TEMPORARY EROSION AND SEDIMENT CONTROL MEASURES SHALL BE DISPOSED OF WITHIN 30 DAYS AFTER FINAL STABILIZATION. FINAL STABILIZATION HAS OCCURRED WHEN ALL SOIL DISTURBING ACTIVITIES ARE COMPLETED AND A UNIFORM PERENNIAL VEGETATIVE COVER WITH A DENSITY OF 70% OF THE COVER FOR UNPAVED AREAS AND AREAS NOT COVERED BY PERMANENT STRUCTURES HAS BEEN EMPLOYED.
- D. BEST MANAGEMENT PRACTICES (BMP'S) AND CONTROLS SHALL CONFORM TO FEDERAL, STATE, OR LOCAL REQUIREMENTS OR MANUAL OF PRACTICE, AS APPLICABLE CONTRACTOR SHALL IMPLEMENT ADDITIONAL CONTROLS AS DIRECTED BY PERMITTING AGENCY OR OWNER.
- E. CONTRACTOR SHALL MINIMIZE CLEARING TO THE MAXIMUM EXTENT PRACTICAL OR AS REQUIRED BY THE GENERAL PERMIT.
- F. GENERAL CONTRACTOR SHALL DENOTE ON PLAN THE TEMPORARY PARKING AND STORAGE AREA WHICH SHALL ALSO BE USED AS THE EQUIPMENT MAINTENANCE AND CLEANING AREA, EMPLOYEE PARKING AREA, AND AREA FOR LOCATING PORTABLE FACILITIES, OFFICE TRAILERS, AND TOILET FACILITIES.
- G. ALL WASH WATER (CONCRETE TRUCKS, VEHICLE CLEANING, EQUIPMENT CLEANING, ETC.) SHALL BE DETAINED AND PROPERLY TREATED OR DISPOSED.
- H. SUFFICIENT OIL AND GREASE ABSORBING MATERIALS AND FLotation BOOMS SHALL BE MAINTAINED ON SITE OR READILY AVAILABLE TO CONTAIN AND CLEAN-UP FUEL OR CHEMICAL SPILLS AND LEAKS.
- I. DUST ON THE SITE SHALL BE CONTROLLED. THE USE OF MOTOR OILS AND OTHER PETROLEUM BASED OR TOXIC LIQUIDS FOR DUST SUPPRESSION OPERATIONS IS PROHIBITED.
- J. RUBBISH, TRASH, GARBAGE, LITTER, OR OTHER SUCH MATERIALS SHALL BE DEPOSITED INTO SEALED CONTAINERS. MATERIALS SHALL BE PREVENTED FROM LEAVING THE PREMISES THROUGH THE ACTION OF WIND OR STORMWATER DISCHARGE INTO DRAINAGE DITCHES OR WATERS OF THE STATE.
- K. ALL STORM WATER POLLUTION PREVENTION MEASURES PRESENTED ON THIS PLAN, AND IN THE STORM WATER POLLUTION PREVENTION PLAN, SHALL BE INITIATED AS SOON AS PRACTICABLE.
- L. DISTURBED PORTIONS OF THE SITE WHERE CONSTRUCTION ACTIVITY HAS STOPPED FOR AT LEAST 14 DAYS, SHALL BE TEMPORARILY SEEDED. THESE AREAS SHALL BE SEEDED NO LATER THAN 14 DAYS FROM THE LAST CONSTRUCTION ACTIVITY OCCURRING IN THESE AREAS.
- M. DISTURBED PORTIONS OF THE SITE WHERE CONSTRUCTION ACTIVITY HAS PERMANENTLY STOPPED SHALL BE PERMANENTLY SEEDED. THESE AREAS SHALL BE SEEDED NO LATER THAN 14 DAYS AFTER THE LAST CONSTRUCTION ACTIVITY OCCURRING IN THESE AREAS. REFER TO THE GRADING PLAN AND/OR LANDSCAPE PLAN.
- N. IF THE ACTION OF VEHICLES TRAVELING OVER THE GRAVEL CONSTRUCTION ENTRANCES IS NOT SUFFICIENT TO REMOVE THE MAJORITY OF DIRT OR MUD, THEN THE TIRES MUST BE WASHED BEFORE THE VEHICLES ENTER A PUBLIC ROAD. IF WASHING IS USED, PROVISIONS MUST BE MADE TO INTERCEPT THE WASH WATER AND TRAP THE SEDIMENT BEFORE IT IS CARRIED OFF THE SITE.
- O. ALL MATERIALS SPILLED, DROPPED, WASHED, OR TRACKED FROM VEHICLES ONTO ROADWAYS OR INTO STORM DRAINS MUST BE REMOVED IMMEDIATELY.
- P. CONTRACTORS OR SUBCONTRACTORS WILL BE RESPONSIBLE FOR REMOVING SEDIMENT IN THE DETENTION POND AND ANY SEDIMENT THAT MAY HAVE COLLECTED IN THE STORM SEWER DRAINAGE SYSTEMS IN CONJUNCTION WITH THE STABILIZATION OF THE SITE.
- Q. ON-SITE & OFFSITE SOIL STOCKPILE AND BORROW AREAS SHALL BE PROTECTED FROM EROSION AND SEDIMENTATION THROUGH IMPLEMENTATION OF BEST MANAGEMENT PRACTICES. STOCKPILE AND BORROW AREA LOCATIONS SHALL BE NOTED ON THE SITE PLAN AND PERMITTED IN ACCORDANCE WITH GENERAL PERMIT REQUIREMENTS.
- R. SLOPES SHALL BE LEFT IN A ROUGHENED CONDITION DURING THE GRADING PHASE TO REDUCE RUNOFF VELOCITIES AND EROSION.
- S. DUE TO THE GRADE CHANGES DURING THE DEVELOPMENT OF THE PROJECT, THE CONTRACTOR SHALL BE RESPONSIBLE FOR ADJUSTING THE EROSION CONTROL MEASURES (SILT FENCES, STRAW BALES, ETC.) TO PREVENT EROSION.
- T. ALL CONSTRUCTION SHALL BE STABILIZED AT THE END OF EACH WORKING DAY. THIS INCLUDES BACKFILLING OF TRENCHES FOR UTILITY CONSTRUCTION AND PLACEMENT OF GRAVEL OR BITUMINOUS PAVING FOR ROAD CONSTRUCTION.
- U. A 3' STRIP OF SOD SHALL BE PLACED ALONG THE EDGE OF ALL PAVING TO ACT AS A SEDIMENT BUFFER AND AID IN THE ESTABLISHMENT OF VEGETATION.

LEGEND

- BOUNDARY LINE
- RIGHT OF WAY LINE
- EASEMENT LINE
- EXISTING CONCRETE CURB AND GUTTER
- PROPOSED CONCRETE CURB AND GUTTER
- PROPOSED FIRE LANE STRIPING
- OHE OVERHEAD ELECTRIC
- UGE UNDERGROUND ELECTRIC
- GAS GAS LINE
- UGT UNDERGROUND TELEPHONE
- FO UNDERGROUND FIBER OPTIC
- SS SANITARY SEWER
- 8"W WATERLINE
- BENCHMARK
- ⊕ FIRE HYDRANT
- ⊕ WATER VALVE
- ⊕ EX. WATER METER PIT
- ⊕ EX. WATER METER
- ⊕ PROP. WATER METER
- ⊕ EX. SPRINKLER VALVE
- ⊕ EX. AUTO SPRINKLER
- ⊕ EX. ELECT. PEDESTAL
- ⊕ EX. ELECT. TRANSFORMER
- ⊕ EX. ELECT. METER
- ⊕ PROP. ELECT. METER
- ⊕ EX. AIR CONDITIONER
- ⊕ EX. SIGNAGE
- ⊕ EX. LIGHT POLE
- ⊕ PROP. LIGHT POLE
- ⊕ EX. BOLLARD
- ⊕ PROP. INLETS (SEE GRADING PLAN FOR TYPE)
- LIMITS OF DISTURBANCE
- SF SILT FENCE
- TD--> TEMPORARY DIVERSION DIKE
- ⊕ SODDING
- ⊕ INLET PROTECTION
- ⊕ CW CONCRETE WASHOUT AREA
- ⊕ EX. POWER POLE
- ⊕ PROP. POWER POLE
- ⊕ EX. TELEPHONE PED.
- ⊕ EX. TELEPHONE MANHOLE
- ⊕ EX. TRAFFIC SIGNAL LIGHT
- ⊕ EX. TRAFFIC CONTROL BOX
- ⊕ EX. FLAG POLE
- ⊕ EX. YARD LIGHT
- ⊕ EX. GREASE TRAP
- ⊕ EX. SS MANHOLE
- ⊕ PROP. SS MANHOLE
- ⊕ EX. GAS METER
- ⊕ PROP. GAS METER
- ⊕ EX. ELECT. MANHOLE
- ⊕ EX. STORM MANHOLE

SEQUENCE OF CONSTRUCTION

- PHASE 1**
- A PRE-CONSTRUCTION MEETING SHALL BE HELD BY THE GENERAL CONTRACTOR'S MANAGER, AND THE OPERATOR'S ENGINEER PRIOR TO LAND DISTURBING ACTIVITIES.
 - PREPARE AND PULL ALL NECESSARY PERMITS.
 - CONSTRUCT TEMPORARY CONSTRUCTION EXITS AT LOCATIONS SHOWN ON THE SWPPP PLANS AND PREPARE TEMPORARY PARKING AND STORAGE AREA. UPON IMPLEMENTATION AND INSTALLATION OF THE FOLLOWING AREAS: TRAILER, PARKING, LAY DOWN, PORTA-POTTY, WELL WASH, CONCRETE WASHOUT, MASONS AREA, FUEL AND MATERIAL STORAGE CONTAINERS, SOLID WASTE CONTAINERS, ETC., DENOTE THEM ON THE SITE MAPS IMMEDIATELY AND NOTE ANY CHANGE IN THE LOCATIONS AS THEY OCCUR THROUGHOUT THE CONSTRUCTION PROCESS.
 - CONSTRUCT THE SILT FENCES ON THE SITE. HALT ALL ACTIVITIES AND CONTACT THE CIVIL ENGINEERING CONSULTANT TO PERFORM INSPECTION AND CERTIFICATION OF BMP'S. GENERAL CONTRACTOR SHALL SCHEDULE AND CONDUCT STORMWATER PRE-CONSTRUCTION MEETING WITH ENGINEER AND ALL GROUND-DISTURBING CONTRACTORS BEFORE PROCEEDING WITH CONSTRUCTION.
 - INSTALL PUBLIC WATER, SEWER AND BOX CULVERT
 - DEMO, CLEAR AND GRUB THE SITE.
 - BEGIN GRADING THE SITE.
 - START CONSTRUCTION OF BUILDING PAD AND STRUCTURES.
 - DISTURBED AREAS OF THE SITE WHERE CONSTRUCTION ACTIVITY HAS CEASED FOR MORE THAN 14 DAYS SHALL BE TEMPORARILY SEEDED AND WATERED.
- PHASE 2**
- INSTALL UTILITIES, UNDER DRAINS, STORM SEWERS, CURB AND GUTTERS.
 - INSTALL INLET PROTECTION DEVICES.
 - INSTALL RIP RAP AROUND OUTLET STRUCTURES.
 - FINALIZE PAVEMENT SUBGRADE PREPARATION.
 - INSTALL BASE MATERIAL AS REQUIRED FOR PAVEMENT.
 - PAVE LOT.
 - REMOVE TEMPORARY CONSTRUCTION EXITS ONLY PRIOR TO PAVEMENT CONSTRUCTION IN THESE AREAS. (THESE AREAS TO BE PAVED LAST)
 - DISTURBED AREAS OF THE SITE WHERE CONSTRUCTION ACTIVITY HAS CEASED FOR MORE THAN 14 DAYS SHALL BE TEMPORARILY SEEDED AND WATERED.
 - FINE GRADE AND INSTALL PERMANENT SEEDING AND PLANTINGS.
 - REMOVE ALL TEMPORARY EROSION AND SEDIMENT CONTROLS DEvised. (ONLY IF SITE IS STABILIZED)
 - REMOVE INLET PROTECTIONS AROUND INLETS AND MANHOLES NO MORE THAN 48 HOURS PRIOR TO PLACING STABILIZED BASE COURSE.



ENGINEERING • PLANNING • CONSULTING
 P.O. Box 14534 Oklahoma City, OK 73113
 405-778-3385
 www.cedarcreekinc.com
 OK CA 5864
 EXP. 06/30/24

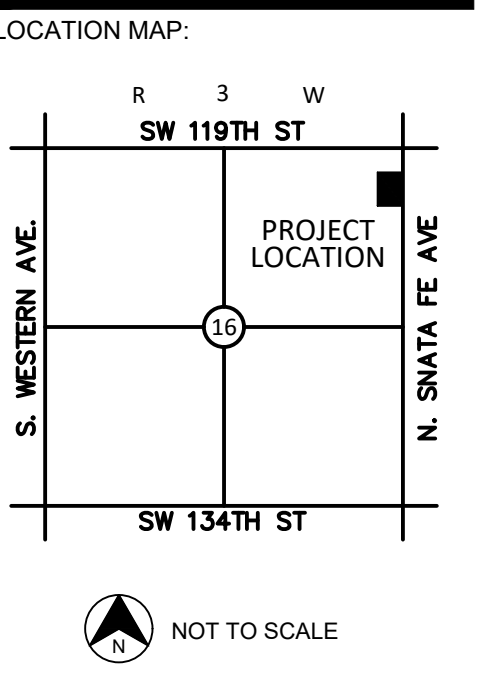

PROJECT:
HIGHLAND WEST JR. HIGH
 901 N. SANTA FE MOORE, OK

PROJECT NUMBER: 23069
 DRAWING DATE: 09.25.23
 ISSUE DATE: 09.25.23

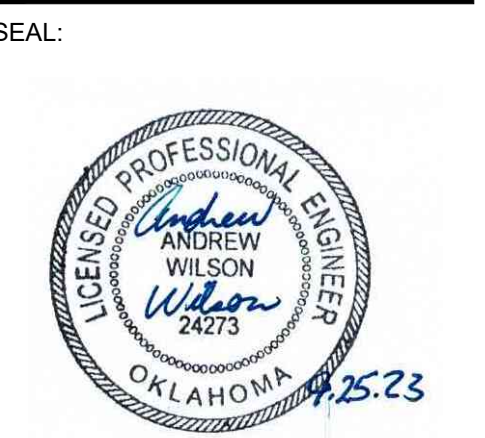

SUBMITTAL:
PERMIT SET

REVISIONS:

MARK	DATE	DESCRIPTION

THESE PLANS AND DRAWINGS ARE NOT TO BE REPRODUCED, CHANGED OR COPIED IN ANY FORM OR MANNER WHATSOEVER WITHOUT FIRST OBTAINING THE WRITTEN PERMISSION AND CONSENT OF CEDAR CREEK CONSULTING INC. THIS SHEET IS NOT TO BE USED FOR CONSTRUCTION UNLESS THE ISSUE DATE IN THE TITLE BLOCK COINCIDES WITH OR POST DATES THE DRAWING DATE. ANY CHANGES MADE FROM THESE PLANS WITHOUT CONSENT OF CEDAR CREEK CONSULTING INC. ARE UNAUTHORIZED AND SHALL RELIEVE CEDAR CREEK CONSULTING OF RESPONSIBILITY FOR ALL CONSEQUENCES ARISING OUT OF SUCH CHANGES.

DRAWING TITLE:
EROSION CONTROL PLAN

SHEET:
C5.00

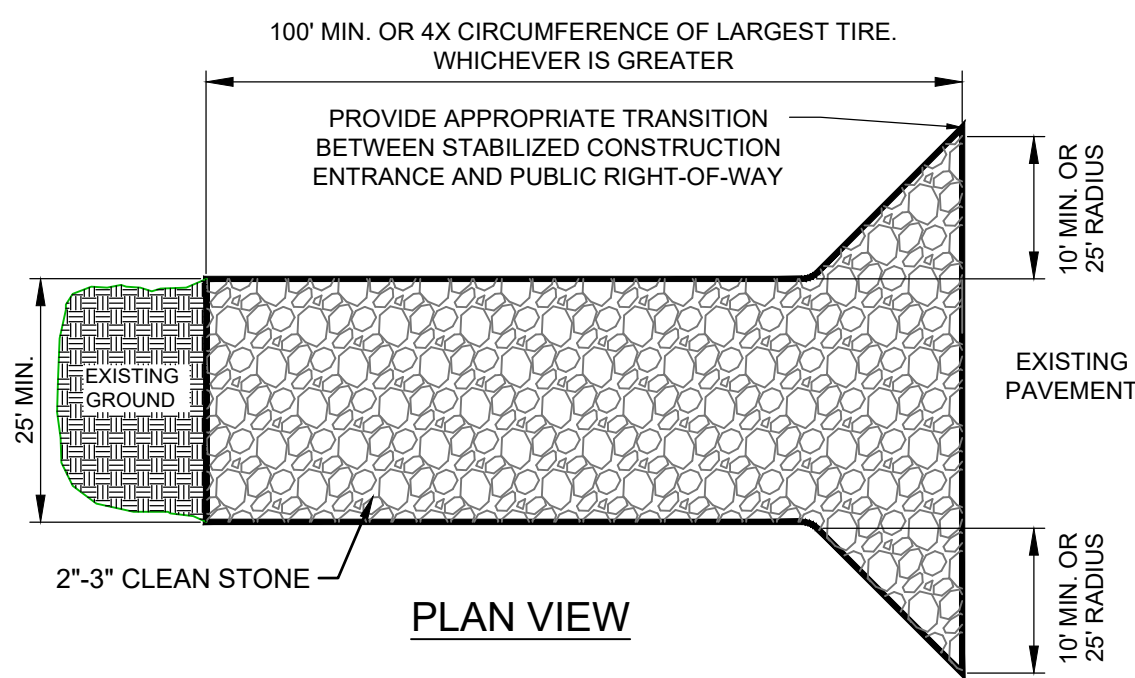
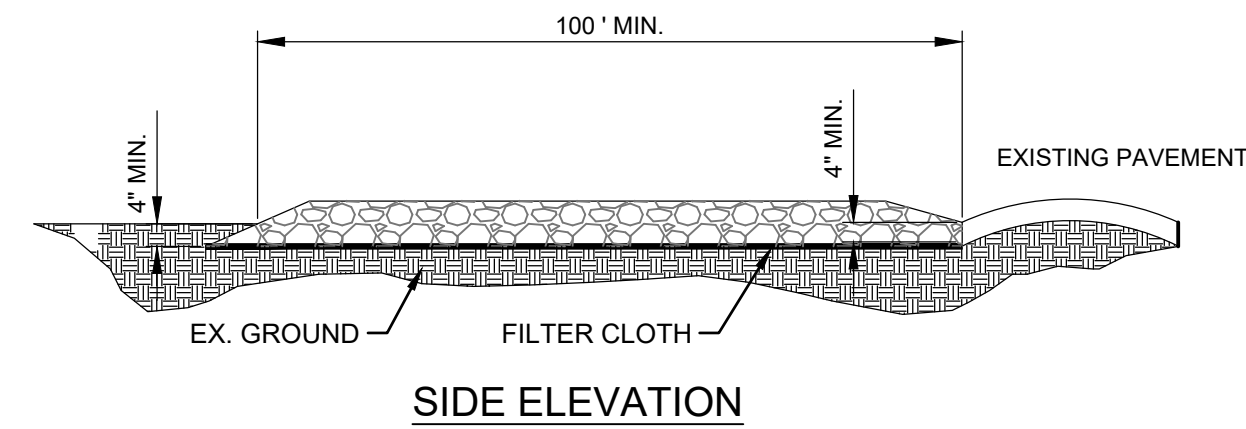

- NOTES:
1. STONE - USE COARSE AGGREGATE (2 - 3 INCH STONE)
 2. LENGTH - AS EFFECTIVE, BUT NOT LESS THAN 100 FEET.
 3. THICKNESS - NOT LESS THAN EIGHT (8) INCHES.
 4. WIDTH - NOT LESS THAN FULL WIDTH OF ALL POINTS OF INGRESS OR EGRESS.
 5. WASHING - WHEN NECESSARY, WHEELS SHALL BE CLEANED TO REMOVE SEDIMENT PRIOR TO ENTRANCE ONTO PUBLIC RIGHT-OF-WAY. WHEN WASHING IS REQUIRED, IT SHALL BE DONE ON AN AREA STABILIZED WITH CRUSHED STONE WHICH DRAINS INTO AN APPROVED SEDIMENT TRAP OR SEDIMENT BASIN. ALL SEDIMENT SHALL BE PREVENTED FROM ENTERING ANY STORM DRAIN, DITCH, OR WATERCOURSE THROUGH USE OF SAND BAGS, GRAVEL, BOARDS OR OTHER APPROVED METHODS.
 6. MAINTENANCE - THE ENTRANCE SHALL BE MAINTAINED IN A CONDITION WHICH WILL PREVENT TRACKING OR FLOWING OF SEDIMENT ONTO PUBLIC RIGHT-OF-WAY. THIS MAY REQUIRE PERIODIC TOP DRESSING WITH ADDITIONAL STONE AS CONDITIONS DEMAND AND REPAIR AND/OR CLEANOUT OF ANY MEASURES USED TO TRAP SEDIMENT. ALL SEDIMENT SPILLED, DROPPED, WASHED OR TRACKED ONTO PUBLIC RIGHTS-OF-WAY MUST BE REMOVED IMMEDIATELY.
 7. 12" X 24" METAL GRATE MAY BE USED. GRATE SHALL BE 25' AWAY FROM PAVEMENT AND APPROPRIATE SEDIMENT CONTROL TRAPPING DEVICE SHALL BE USED AT GRATE OUTLET POINT.

STABILIZED CONSTRUCTION ENTRANCE
 NOT TO SCALE

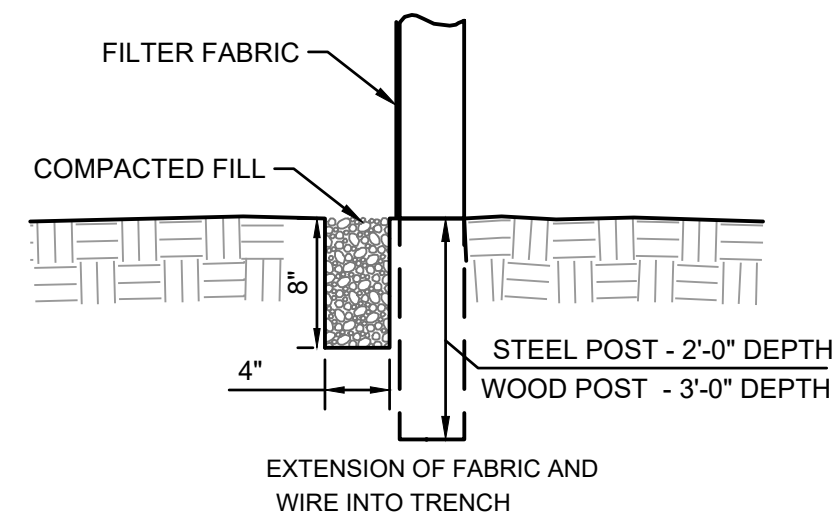
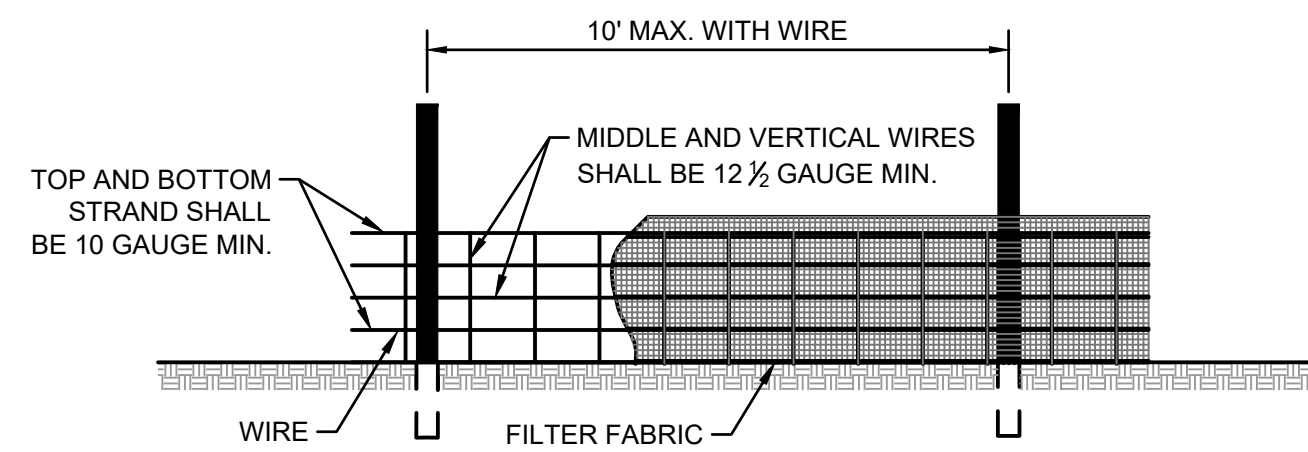

- NOTES:
1. WIRE SHALL BE A MINIMUM OF 32" IN WIDTH AND SHALL HAVE A MINIMUM OF 6 LINE WIRES WITH 12" STAY SPACING.
 2. FILTER FABRIC SHALL BE A MINIMUM OF 36" IN WIDTH AND SHALL BE FASTENED ADEQUATELY TO THE WIRE.
 3. STEEL POST SHALL BE 5'-0" IN HEIGHT AND BE OF THE SELF-FASTENER ANGLE STEEL TYPE.
 4. WOOD POST SHALL BE 6'-0" IN HEIGHT AND 3" IN DIAMETER.

SILT FENCE DETAIL
 NOT TO SCALE

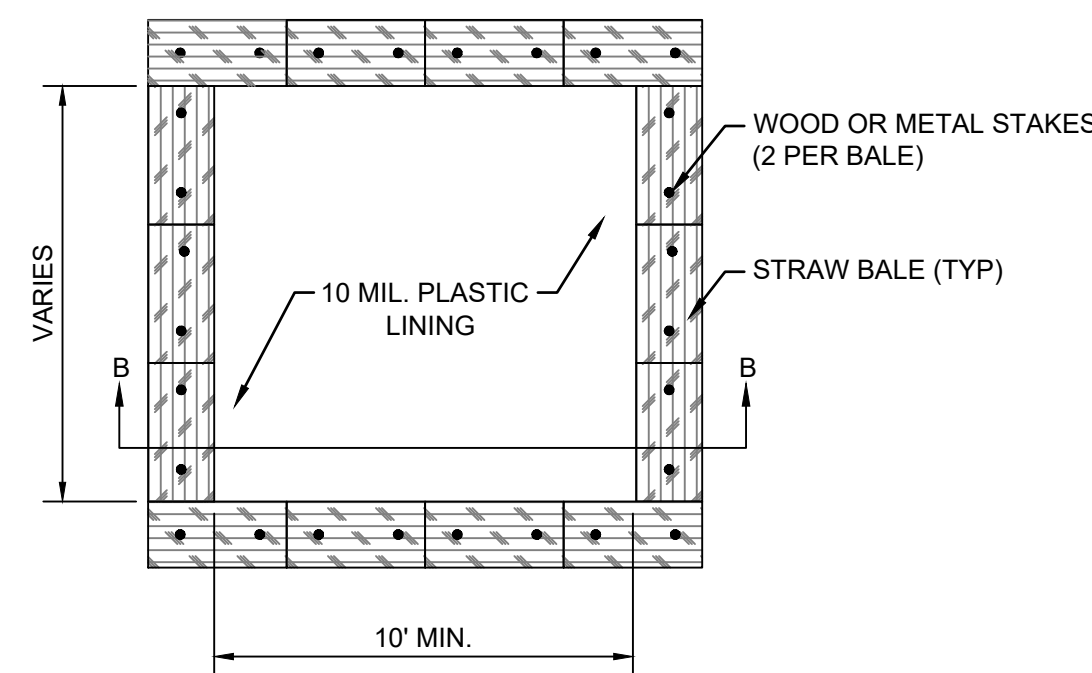
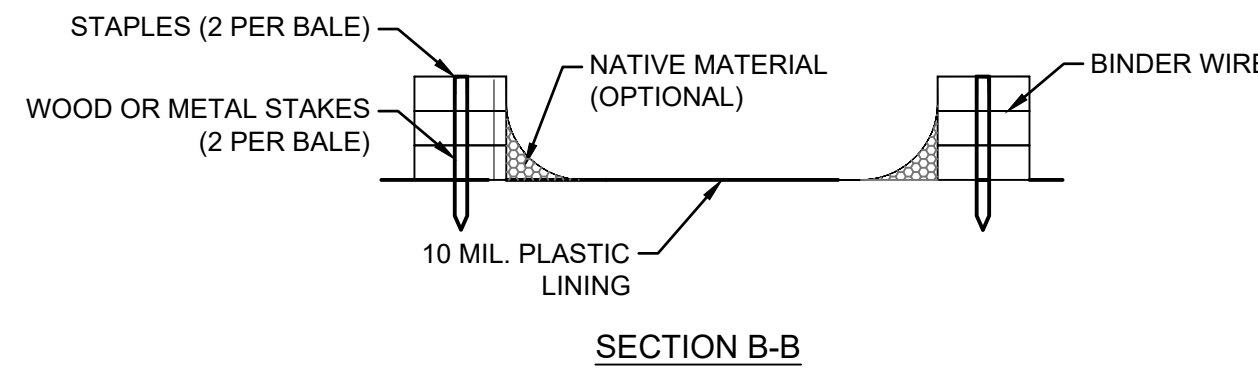

TYPE 'ABOVE GRADE' WITH STRAW BALES

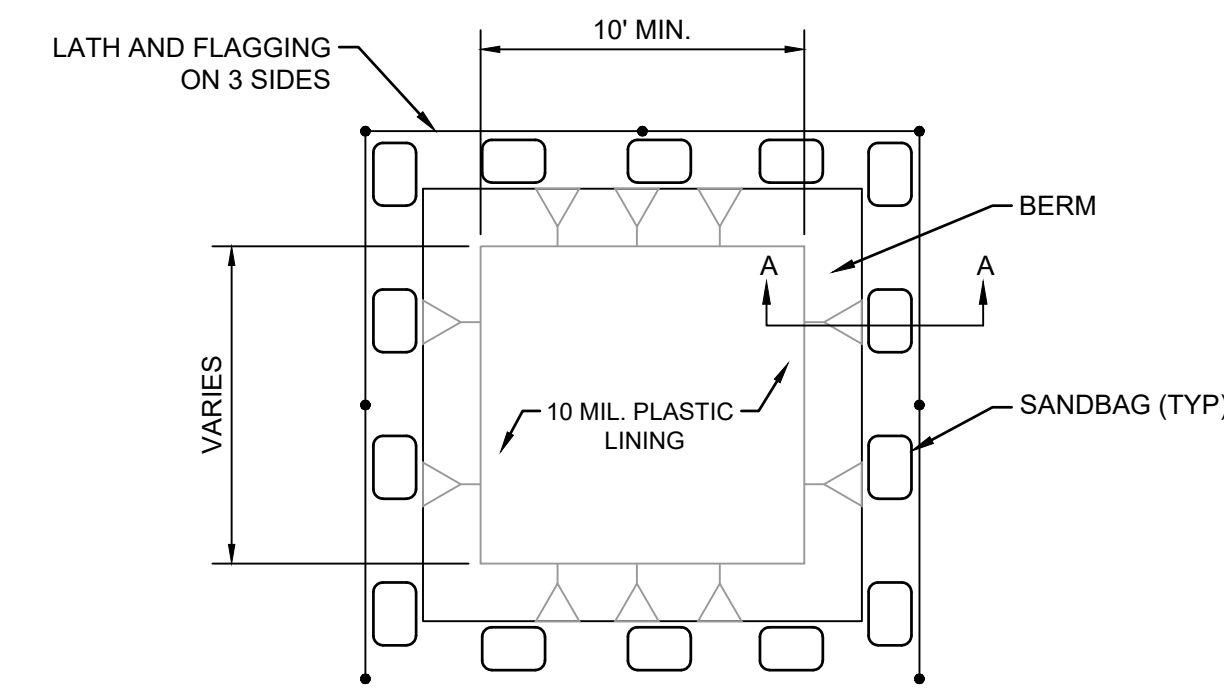
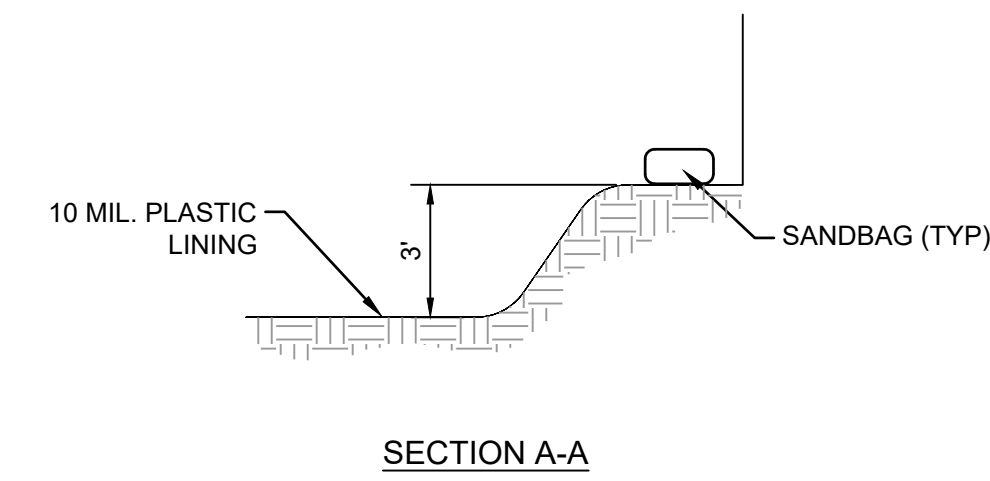

TYPE 'BELOW GRADE'

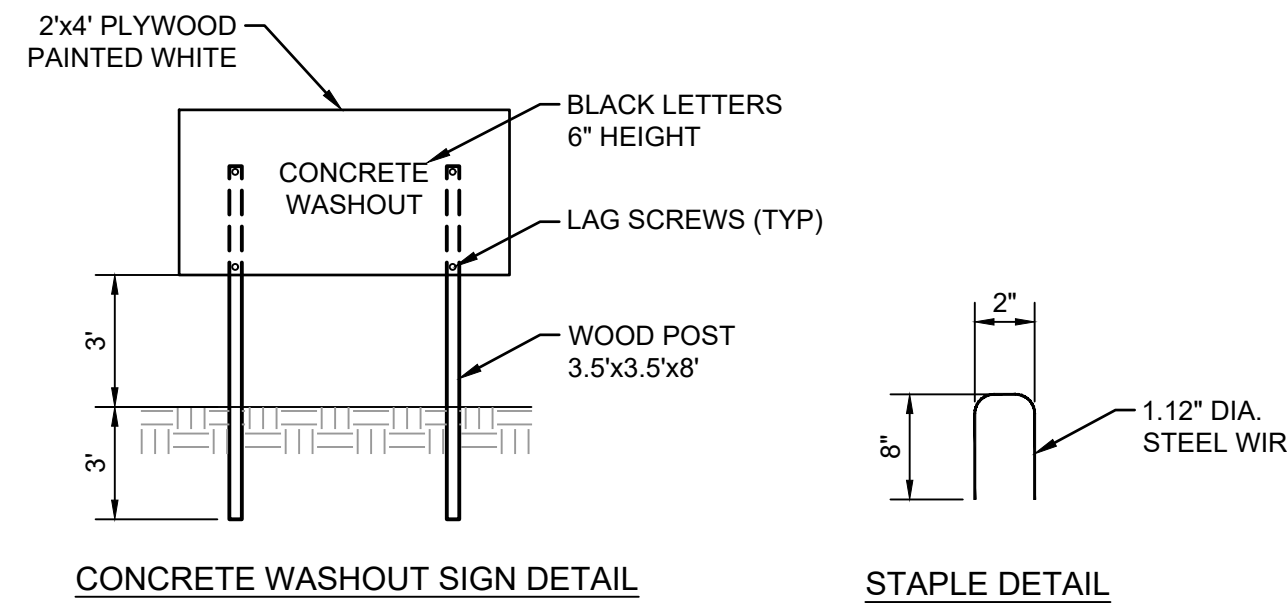

- NOTES:
1. ACTUAL LAYOUT TO BE DETERMINED IN THE FIELD.
 2. A CONCRETE WASHOUT SIGN SHALL BE INSTALLED WITHIN 30' OF THE TEMPORARY CONCRETE WASHOUT FACILITY.
 3. MATERIALS USED TO CONSTRUCT TEMPORARY CONCRETE WASHOUT FACILITIES SHALL BE REMOVED FROM THE SITE OF THE WORK AND DISPOSED OF OR RECYCLED.
 4. HOLES, DEPRESSIONS OR OTHER GROUND DISTURBANCE CAUSED BY THE REMOVAL OF THE TEMPORARY CONCRETE WASHOUT FACILITIES SHALL BE BACKFILLED, REPAIRED AND STABILIZED TO PREVENT EROSION.

CONCRETE WASHOUT DETAIL
 NOT TO SCALE

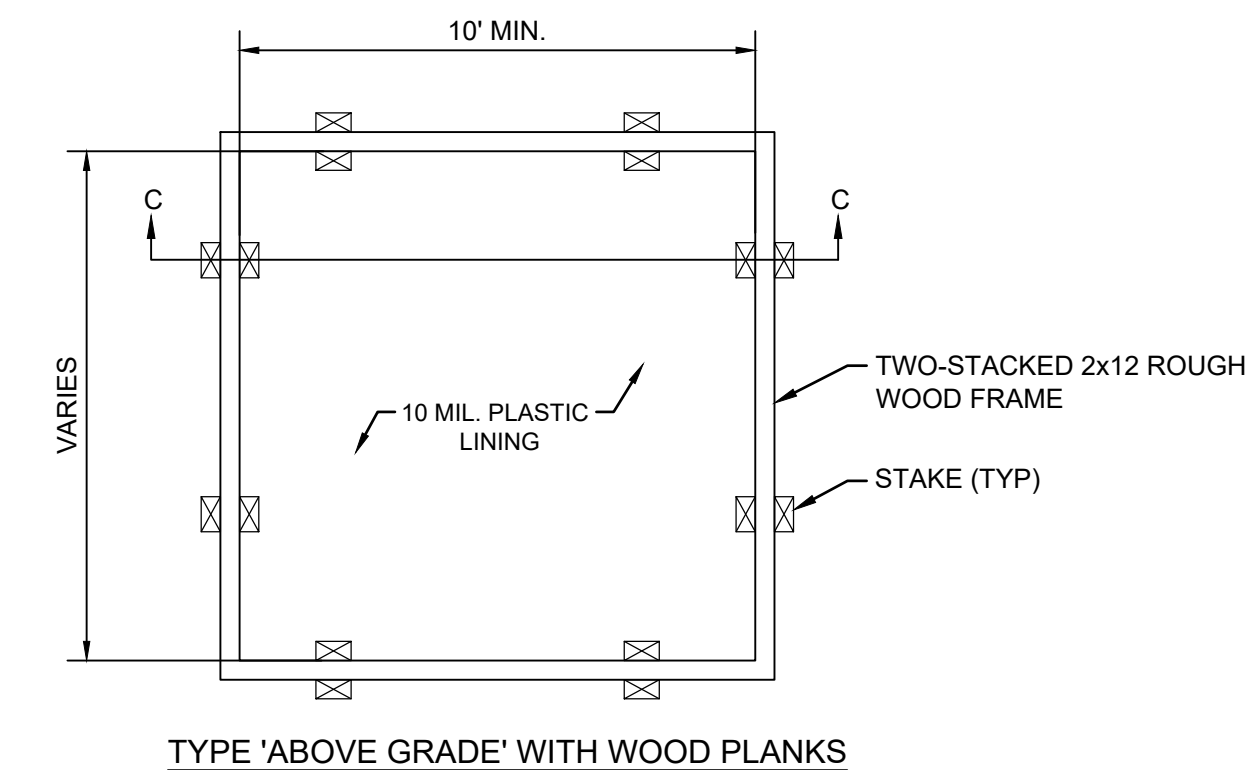
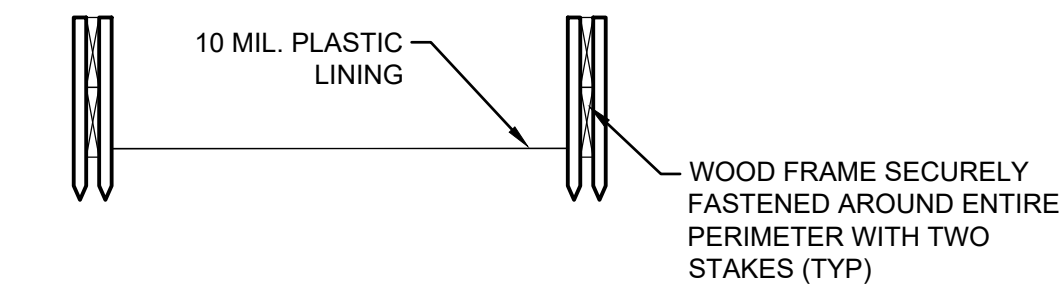

TYPE 'ABOVE GRADE' WITH WOOD PLANKS

LOCATION MAP:

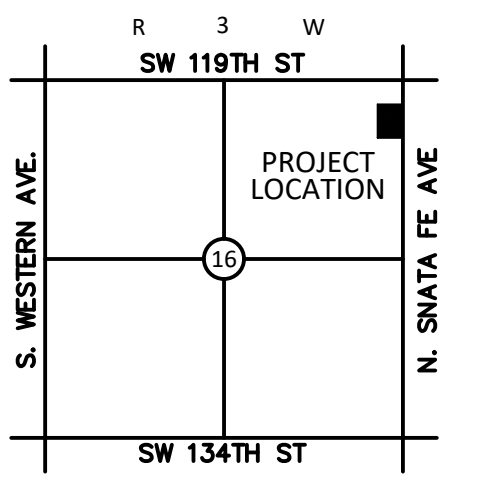

NOT TO SCALE

PROJECT:

HIGHLAND WEST JR. HIGH

901 N. SANTA FE MOORE, OK

PROJECT NUMBER: 23069
 DRAWING DATE: 09.25.23
 ISSUE DATE: 09.25.23

SEAL:



SUBMITTAL:

PERMIT SET

REVISIONS:

MARK DATE DESCRIPTION

THESE PLANS AND DRAWINGS ARE NOT TO BE REPRODUCED, CHANGED OR COPIED IN ANY FORM OR MANNER WHATSOEVER WITHOUT FIRST OBTAINING THE WRITTEN PERMISSION AND CONSENT OF CEDAR CREEK CONSULTING INC. THIS SHEET IS NOT TO BE USED FOR CONSTRUCTION UNLESS THE ISSUE DATE IN THE TITLE BLOCK COINCIDES WITH OR POST DATES THE DRAWING DATE. ANY CHANGES MADE FROM THESE PLANS WITHOUT CONSENT OF CEDAR CREEK CONSULTING INC. ARE UNAUTHORIZED AND SHALL RELIEVE CEDAR CREEK CONSULTING OF RESPONSIBILITY FOR ALL CONSEQUENCES ARISING OUT OF SUCH CHANGES.

DRAWING TITLE:

EROSION CONTROL DETAILS

SHEET:

C5.01